

LOCATION PLAN



LEGEND

- LDP Application Area
- ⊠ Garage Location

ENDORSEMENT TABLE

This Local Development Plan has been approved by the Executive Director, Planning of the Metropolitan Redevelopment Authority.

..... Date
Executive Director, Planning

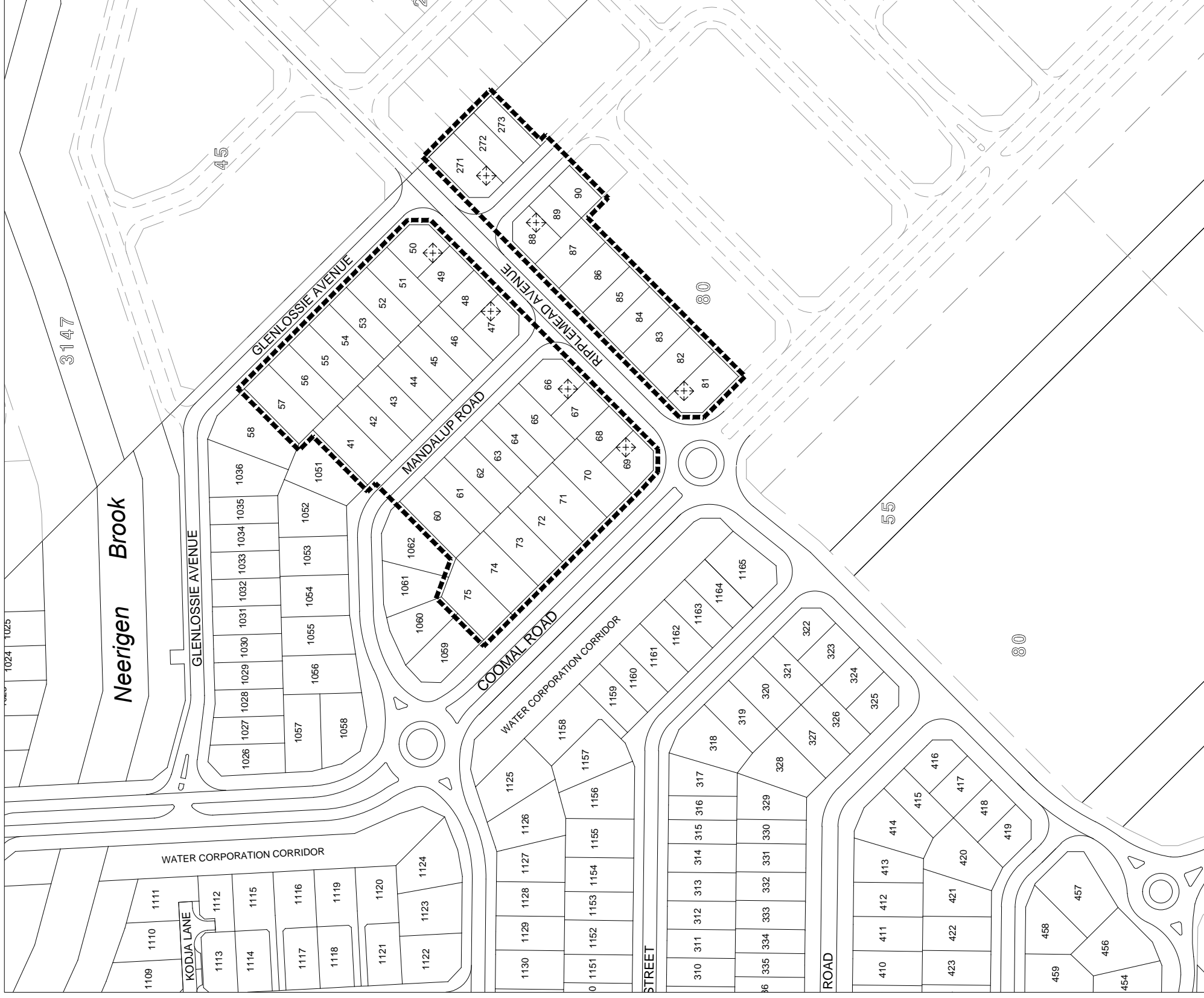

LDP PROVISIONS

The provisions of the Armadale Redevelopment Scheme 2 (Scheme 2), the Wungong Urban Water Project Area Design Guidelines (Design Guidelines) and State Planning Policy 7.3 Residential Design Codes Volume 1 (R-Codes) are varied as detailed within this Local Development Plan (LDP). All other requirements of the Scheme 2, Design Guidelines and R-codes shall be satisfied in all other matters, to the discretion of the Metropolitan Redevelopment Authority.

The Suburban Zone place code applies to all lots contained within the Local Development Plan unless otherwise noted. A residential density coding of R35 applies to the Suburban Zone. Consultation with adjoining or other land owners to achieve a variation to the Scheme 2, Design Guidelines and R-Codes, as provided for by the Local Development Plan, is not required.

SITE ACCESS AND GARAGES

1. Garages to be located in accordance with the nominated location on the LDP, minor discretions to garage location may be applied.